

TELLARINI SERIES BS HYDRAULIC DRIVE BRONZE AND STAINLESS TRANSFER PUMPS



Self priming pumps flanged for hydraulic motor

- Capacities from 40 to 260 l/min.
- Maximum head 40m. • Maximum suction 6m.
- Suitable for a wide range of clean liquids such as:

Bronze: water, seawater, oil, diesel etc.

Stainless: seawater, corrosive liquids, fertilisers, etc.

Applications include agricultural, civil engineering and highway maintenance machinery.

- Reverse flow capability
- All Flanged for connection to Group 2 hydraulic motors.

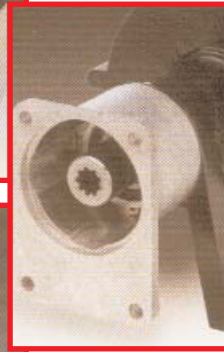

MATERIAL SPECIFICATION

BS • Pump body, Impeller: Bronze - Shaft : AISI 304

ALBS • Pump body, Impeller and Shaft : AISI 316

SEALS

BS • NBR Lip seal as standard (>90°C)

Options: • Viton Lip seal (>130°C)

• Mechanical seal Ceramic/Graphite/NBR (>90°C)

• Mechanical seal Ceramic/Graphite/Viton - (>130°C)

ALBS • Mechanical seal ceramic/graphite/NBR (>90°C)

Options: • Mechanical seal Ceramic/Graphite/EPDM

• Mechanical seal Silicon Carbide/Viton (>130°C)

• Mechanical seal Ceramic/Graphite/Viton - (>130°C)

• Mechanical seal AISI 316/Graphite/Teflon

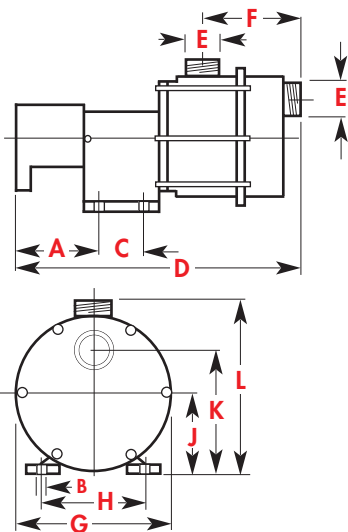

MODEL	DIMENSIONS											WEIGHT KG
	A	B	C	D	E	F	G	H	J	K	L	
BS 30	88	9	46	307	1½" M	103	158	125	74	135	180	6.6
BS 40	88	9	46	307	1½" M	103	158	125	74	135	180	7.1
BS 50	91	9	54	331	2" M	105	200	140	100	158	219	9.6
ALBS 40	88	9	46	312	1½" M	112	166	125	74	135	187	6.9
ALBS 50	91	9	54	336	2" M	118	200	140	100	159	226	8.5

MODEL	CAPACITIES - L/M											MAX RPM
	1400 RPM			1900 RPM			2800 RPM					
	H (m)	1	5	10	1	5	10	1	10	20	30	
BS 30	89	71	43	123	108	90	166	150	129	105	2900	
BS 40	149	119	78	192	168	139	258	234	203	167	2900	
BS 50	262	227	180	360	333	299	-	-	-	-	1900	
ALBS 40	137	112	76	177	158	132	-	-	-	-	2400	
ALBS 50	205	176	140	-	-	-	-	-	-	-	1800	

© Descriptions, technical data and features contained in this leaflet are not binding. We reserve the right to make any necessary modifications without prior notice.

