

SEMISOM VORTEX SEWAGE PUMPS

Heavy duty for 50/65mm solids handling

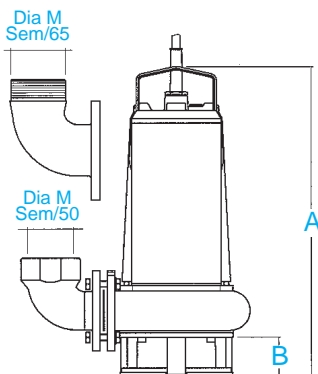

Designed for sewage and domestic, industrial and agricultural wastewater applications, these powerful Semisom pumps combine excellent solids handling characteristics with long service life. Model 754/65 features a low r.p.m 4-pole motor which is particularly suitable for abrasive media applications. Supplied with 10m H07RN-F cable. Motor casing, tie rods, handle and shaft: Stainless steel Cover, Volute and Impeller: Cast iron Silicon carbide/Alumina mechanical seal. Float switch, control box with indicator light and thermal protector switch as standard on 1-phase.

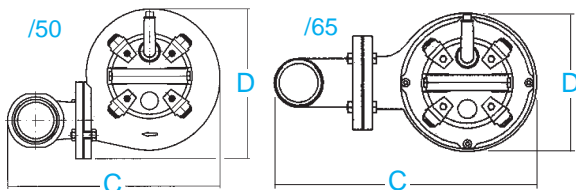
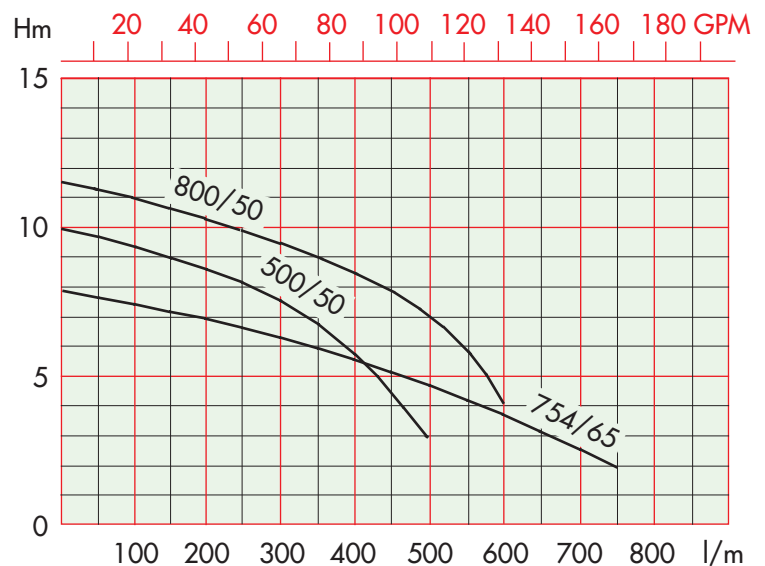

TECHNICAL DATA										
SEMISOM MODEL	M=230/1/50 T=400/3/50	NOMINAL		NOM. Amp	DIMENSIONS mm					WEIGHT Kg
		kW	HP		A	B	C	D	Dia M	
500/50	M	1.1	1.5	9.2	518	70	354	254	2"	32.0
500/50	T	1.1	1.5	3.3	508	70	354	254	2"	30.5
800/50	M	1.5	2.0	11.4	543	70	362	254	2½"	34.5
800/50	T	1.5	2.0	4.0	508	70	362	254	2½"	31.0
754/65	M/T	1.2	1.6	7.7/3.3	569	65	417	222	3"	38.5

© Descriptions, technical data and features contained in this leaflet are not binding. We reserve the right to make any necessary modifications without prior notice.

