

# CMV/CTV VERTICAL MULTISTAGE PUMPS

## Series 110/230/330



Series 110/230/330 vertical multistage pumps are available in both 230/1/50 and 400/3/50 models.

The pump ends comprise head, foot and motor coupling in mechanical cast iron; casing, tie rods, shaft and fixings in stainless steel; impellers and diffusers in reinforced polycarbonate; bearing in self-lubricating bronze; and mechanical seal in graphite/ceramics. The asynchronous two pole motors feature ball bearings (lower thrust bearing); frame, cover and B14 flange in die-cast aluminium alloy; external ventilation.

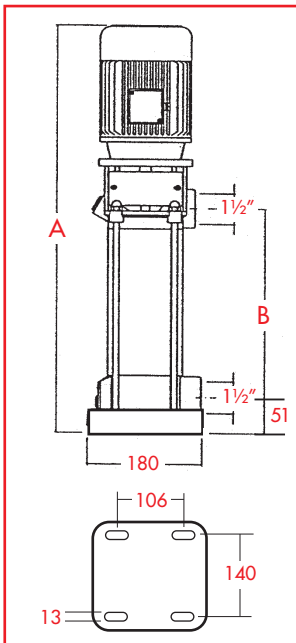
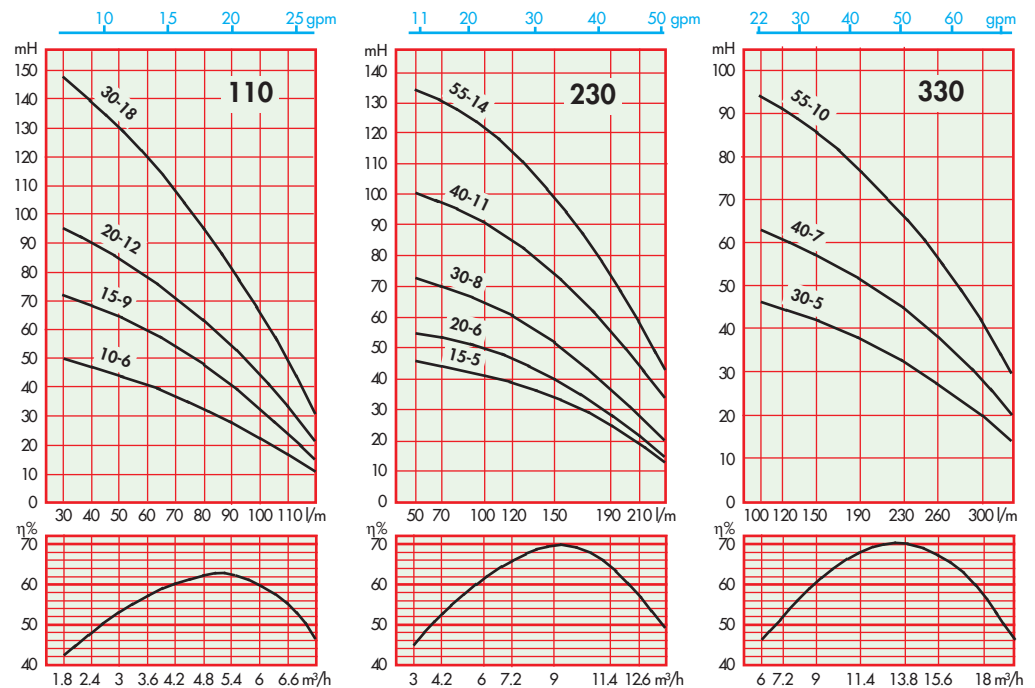

For higher capacities, please refer to separate data sheet covering CTV Series 530/700 models.

230/1/50 Model	Power kW	HP	Nom Amp	Dimensions A	B	Weight kg
CMV10-6/110	0.75	1	6.2	662	286	22.2
CMV15-9/110	1.1	1.5	8	752	376	25.8
CMV20-12/110	1.5	2	10.9	859	466	28.3
CMV30-18/110	2.2	3	16.5	1093	646	35.0
CMV15-5/230	1.1	1.5	8	662	286	24.1
CMV20-6/230	1.5	2	10.9	715	322	25.8
CMV30-8/230	2.2	3	16.5	841	394	31.7
CMV30-5/330	2.2	3	16.5	733	286	29.6

400/3/50 Model	Power kW	HP	Nom Amp	Dimensions A	B	Weight kg
CTV10-6/110	0.75	1	1.9	665	286	21.0
CTV15-9/110	1.1	1.5	2.7	755	376	24.8
CTV20-12/110	1.5	2	3.3	859	466	26.3
CTV30-18/110	2.2	3	5.3	1063	646	33.5
CTV15-5/230	1.1	1.5	2.7	665	286	23.1
CTV20-6/230	1.5	2	3.3	715	322	23.8
CTV30-8/230	2.2	3	5.3	811	394	30.2
CTV40-11/230	3	4	6.8	951	502	38.0
CTV55-14/230	4	5.5	8.5	1059	610	41.0
CTV30-5/330	2.2	3	5.3	703	286	28.1
CTV40-7/330	3	4	6.8	807	358	35.3
CTV55-10/330	4	5.5	8.5	915	466	38.1

© Descriptions, technical data and features contained in this leaflet are not binding. We reserve the right to make any necessary modifications without prior notice.

